



Yuasa Technical Data Sheet

Yuasa B49-6 - Conventional 6 Volt Battery

Performance

Voltage	6V
Capacity (10-hour)	8Ah
Capacity (20-hour)	8.4Ah

Dimensions ($\pm 2\text{mm}$)

Length	91mm
Width	83mm
Height	161mm

Weights & Measures

Mean Weight with Acid	2.1kg
Acid Volume	0.5l

Technology

Technology	Cast Sb/Sb
Separator	Reinforcing fiber+Glass Fiber



Cell Assembly Layout

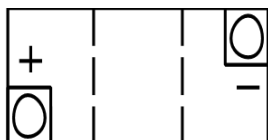

Terminal Type - 6

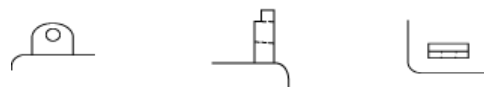

Data Sheet generated on 24/09/2021 - E&OE

